

FOIL THICKNESS GAUGE

**** code 188G ****

Thickness gauge to determine the thickness of foil and all kind of thin materials.

Measuring range 0 - 1 mm, Resolution 0.001 mm.

Self closing thickness gage with highest accuracy and resolution.

Model Information

- Thickness gauge for foils and thin materials with a resolution of 0.001 mm.
- With isolated handle for highest accuracy (prevents transfer of heat from operators hand to the gauge).
- Measuring by spring force.
- Opening by lifting device (lever) - self closing.



Available models

Mesdan code	Model	Measuring range	Resolution	Depth of jaw
188G	F-1000-30	1 mm	0.001 mm	30 mm

Feeler shape

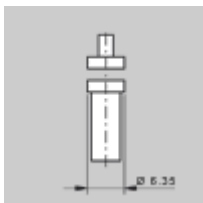

Feeler F (flat)

For soft leather, plywood, fiberboard, etc.
diameter 6.35 mm

Accessories



Foot

Enables on-table operation

*Photographs and descriptions of the present leaflet have to be considered as purely indicative and not binding.
*Le immagini e le descrizioni del presente catalogo sono da ritenersi puramente indicative e non vincolanti.

FOIL THICKNESS GAUGE

**** code 188G ****

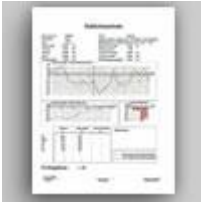

Calibration Report

For the dial gauge a specific test report including calibration report can be delivered.

Calibration report, available as optional, code 188.CC1

Delivery includes



Thickness gauge with transport packing case.

Specification

Resolution:	0.001 mm
Measuring range:	1 mm
Depth of jaw:	30 mm
Scale diameter:	54 mm
Measuring pressure:	2 N
on request:	0.4 N/4 N
Feeler shape:	F
Measuring principle:	Self closing
Weight, net (gross):	340 g (390 g)
Specification subject to change without notice!	
*Photographs and descriptions of the present leaflet have to be considered as purely indicative and not binding. *Le immagini e le descrizioni del presente catalogo sono da ritenersi puramente indicative e non vincolanti.	

*Photographs and descriptions of the present leaflet have to be considered as purely indicative and not binding.
*Le immagini e le descrizioni del presente catalogo sono da ritenersi puramente indicative e non vincolanti.